

Valor HD Dual Crossbar Monitor Arm

The next generation of Valor is here! The new Valor HD dual crossbar monitor arm offer support for two monitors up to 32" in size and 9kg each in weight. The optimised head design and handle ensures smooth-adjustment and a solid, nondroop fixing.

The crossbar solves problems other dual arms have, such as monitor alignment and distance from user. Mostly assembled out of the box, the Valor HD Dual can be assembled in mere minutes with minimal tools required.

The streamline top clamp allows for installation without the need to crawl under a worktop, and helps avoid underdesk wiring already in place.



Product Type	Heavy Duty Dual Monitor Arm
Weight Capacity	1 - 9kg flat screen 7.5kg max for curved monitors
Mounting	Streamline top clamp Bolt through grommet kit included
Cable Management	Cable management on both sections and at back of arm
Features	Max reach 554mm, max height 474mm to centre of screen, 20° tilt, 20° pivot, tension indicator, spring tensioned HD head, very fast install time
Rotation Stop	180° lock and 360° swivel options
Quick Release	Lockable quick release Vesa plate, 75mm and 100mm portrait and landscape options
Finish	Black, White
Warranty	7 Years

Valor HD Dual Crossbar Monitor Arm

Arm Dimensions

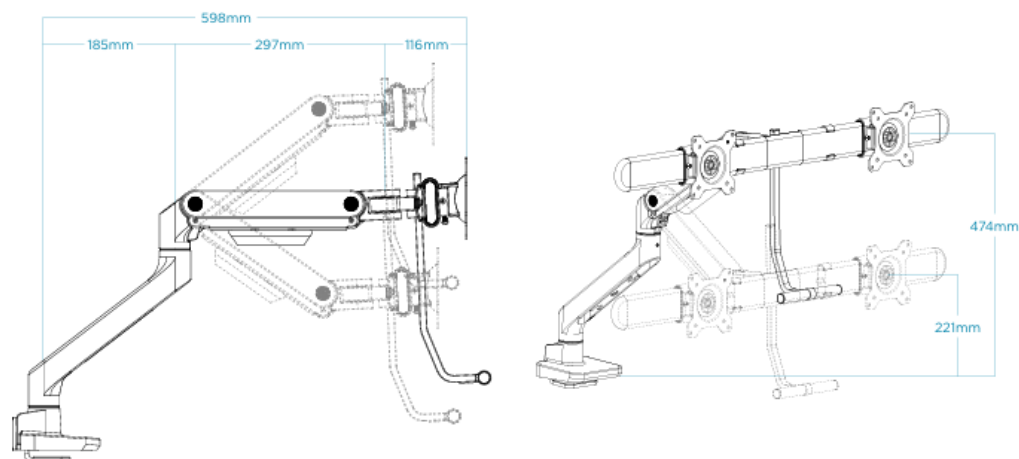

Arm Details

